



prima

PRCGH100

Extractors

Manual for Installation, Use and Maintenance

Important

The manufacturer cannot be held responsible for injuries or losses caused by incorrect use or installation of this product. Please note that the manufacturer reserves the right to invalidate the guarantee supplied with this product following incorrect installation or misuse of the appliance or use in a commercial environment.

This appliance is not designed to be used by people (including children) with reduced physical, sensorial or mental capacity, or who lack experience or knowledge about it, unless they have had supervision or instructions on how to use the appliance by someone who is responsible for their safety.

Under no circumstances should any external covers be removed for servicing or maintenance except by suitably qualified personnel.

Appliance information:

Please enter the details on the appliance rating plate below for reference, to assist Customer Care in the event of a fault with your appliance and to register your appliance for guarantee purposes.

Appliance Model

Serial Number

CE Declarations of Conformity:

This appliance has been manufactured to the strictest standards and complies with all applicable legislation, including Gas safety, Electrical safety (LVD) and Electromagnetic interference compatibility (EMC).

IMPORTANT INFORMATION FOR CORRECT DISPOSAL OF THE PRODUCT IN ACCORDANCE WITH EC DIRECTIVE 2002/96/EC.

At the end of its working life, the product must be taken to a special local authority waste collection centre or to a dealer providing appliance recycling services. Disposing of a household appliance separately avoids possible negative consequences for the environment and health. It also enables the constituent materials to be recovered, saving both energy and resources.

As a reminder of the need to dispose of household appliances separately, the product is marked with a crossed-out wheeled dustbin. 

Please note:

- Under no circumstances should the extractor be connected to any gas ventilation system, flue system or hot air ducting system.
- Do not vent the extractor into an attic or loft space.
- Only house the extractor in rooms with adequate ventilation. Remember that the extractor is powerful and whatever air is extracted needs to be replaced.
- Do not tile the extractor in. It should be removable for service or maintenance.
- Do not use silicone sealant to secure the hood to the wall.
- You must be able to isolate the extractor from the mains electrical supply after installation.
- Steam cleaners must not be used when cleaning this appliance.
- The performance of your extractor will vary depending on a number of factors. These include: type of extraction, length of ducting, room volume, ventilation available and cleanliness of the filters.

Using your Extractor

For best performance, you should switch on the extractor 15 minutes before starting to cook and leave it to run for approximately 15 minutes after the end of cooking.

Control Panel

- A – Power off button
- B – Speed level buttons
- C – Light button

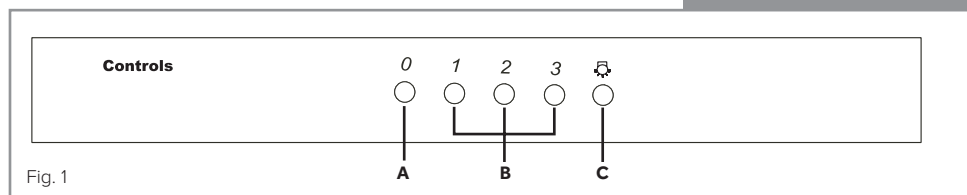

To switch the extractor light on or off

- Press button C.

To switch on the extractor or change the motor speed at any time when the extractor is running

- Press the relevant speed button (B) for the first, second or third speed as required.

To switch the extractor off

- Press button A.

Care and Maintenance

IMPORTANT : DO NOT PERFORM MAINTENANCE OR CLEANING OF THE EXTRACTOR WITHOUT FIRST SWITCHING OFF THE ELECTRICITY SUPPLY.

Cleaning

You should use a nonabrasive cleaner. Any abrasive cleaner (including Cif) will scratch the surface and could erase the control panel markings.

You can clean your extractor effectively by simply using a dilute solution of water and mild detergent and drying to a shine with a clean cloth.

Cleaning the grease filter

The grease filter should be kept clean to minimise the risk of fire.

At least once a month you should remove and clean the grease filter with hot soapy water. You can also wash the grease filter in a dishwasher, ensuring that you place it in an upright position to prevent damage from other items in the dishwasher. After rinsing and drying, replace the filter.

To remove the grease filter, push in the button on the handle and then pull down on the filter at the front. When you have released it at the front, then you can pull out the filter. To replace the grease filter, repeat the steps in reverse.

Please note:

Cleaning the grease filter in the dishwasher may lead to discolouration. This is normal and does not constitute a fault with the appliance.

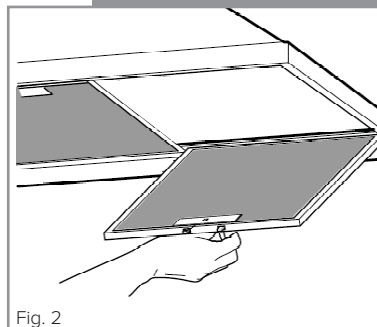
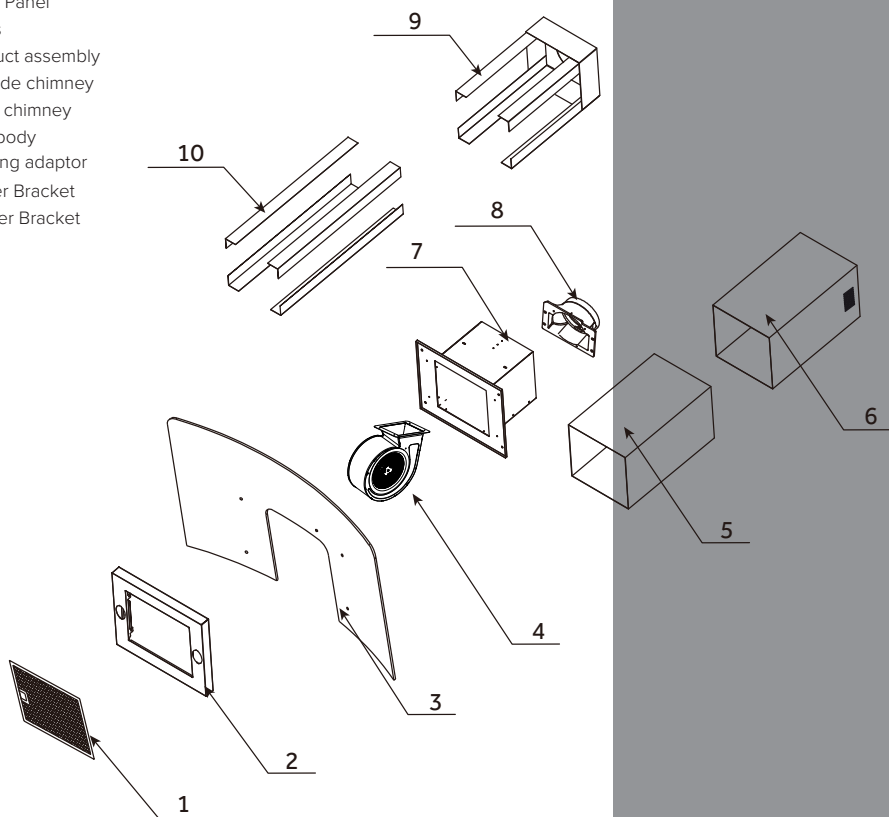

Fig. 2

Parts identification

Parts Name

1. Filter assembly
2. Front Panel
3. Glass
4. Air duct assembly
5. Outside chimney
6. Inner chimney
7. Mainbody
8. Ducting adaptor
9. Upper Bracket
10. Lower Bracket



Changing the Light

NOTE: LED lights replacement must be done by a qualified electrician.

IMPORTANT: DO NOT PERFORM MAINTENANCE OR CLEANING OF THE EXTRACTOR WITHOUT FIRST SWITCHING OFF THE ELECTRICITY SUPPLY.

Check with your local retailer or dealer to buy new same LED lights for replacement.

Remove the lamp by flat-head screwdriver (Fig.3-I).

Pull out the lamp. Unplug the lamp wire connector. Replace the lamp (Fig.3-II).

Plug wire connector with new lamp. Put the new lamp into lamp holder. Push the LED lamp into the hole with sound of snap(Fig.3-III).

The light is designed for use during cooking and not for general room illumination. Extended use of the light can reduce the life span of the lights.

Lights replacement is not covered by the guarantee.

230V 2X1W LED MAX

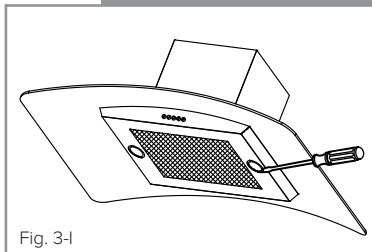

Fig. 3-I

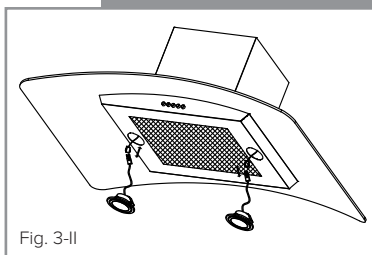

Fig. 3-II

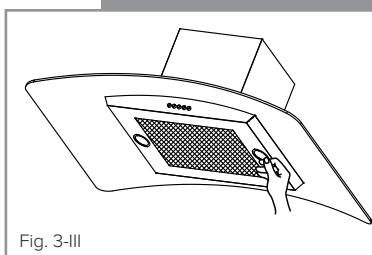

Fig. 3-III

Charcoal filter installation(Re-circulating only)

IMPORTANT: DO NOT ATTEMPT TO MAINTAIN OR CLEAN THE EXTRACTOR WITHOUT FIRST SWITCHING OFF THE ELECTRICITY SUPPLY.

In re-circulating mode, air is vented back into the kitchen through the opening in the cooker hood.

This method is advised if you are not using your hob intensively. Re-circulated air requires the use of charcoal filters to remove odours. These are included with the cooker hood.

To ensure the best performance from your cooker hood, the charcoal filter should be replaced every 3-4 months, dependent on use. Check with your local retailer or dealer for information on how to obtain replacement charcoal filters.

Note: This charcoal filter is non-washable and must be replaced as required. To install a new charcoal filter, first remove the grease filter, as shown in Fig.4.

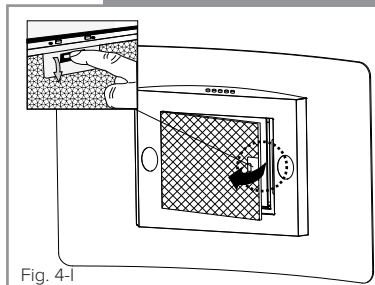

Fig. 4-I

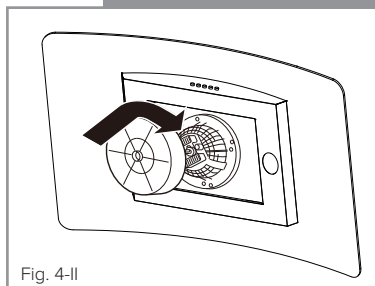

Fig. 4-II

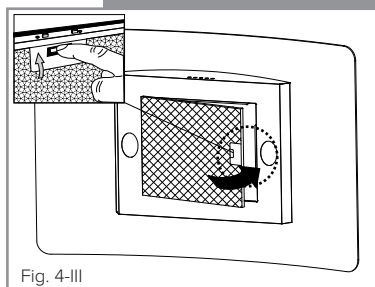

Fig. 4-III

Electrical Information

Mains electrical voltage: 230 – 240Vac, 50Hz

Total rated power consumption:

112W

Troubleshooting

Your cooker hood is equipped with a motor protection device that will switch off the motor to prevent damage from overheating. This may happen during cooking when most or all of the zones/burners are being used simultaneously, or if your cooker hood is installed incorrectly, lower than the recommended height.

This is normal, and the extractor will work again once the motor has cooled sufficiently.

GUARANTEE

Your new product is guaranteed against defects in materials and/or workmanship. Any parts found to be defective will be repaired or replaced at our discretion. All repairs must be carried out by an authorised Repair Agent. Your extractor comes with a 5 years Parts 2 years Labour Guarantee.

RE Guarantee – the hood comes with 5/2 years "if registered with PrimaCare within 30 days of purchase" (otherwise 1/1 warranty).

THIS GUARANTEE IS VALID PROVIDING THAT :

- The appliance has been installed by a suitably qualified person
- Installation has been carried out in accordance with instructions and current legislation
- Proof of purchase can be produced
- The appliance has been used for domestic purposes only
- The appliance has not been tampered with or repair attempted or modified by any unauthorised person

THIS GUARANTEE DOES NOT COVER :

- Damage by misuse, neglect or transit
- Use of parts that have not been recommended
- Routine maintenance, general wear & tear and installation faults
- Rubber seals, removable glass and/or plastic parts, fuses or light bulbs which all need replacing periodically
- Second-hand or reconditioned appliances
- Appliances used for commercial or professional purposes

This guarantee does not in any way affect your statutory legal rights.

INSTALLATION

Tools required

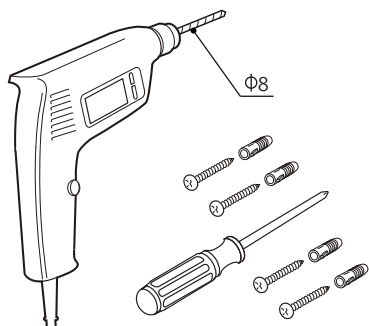

Fig. 5

Fix damper on the unit by 4 pieces ST4X10 screws.

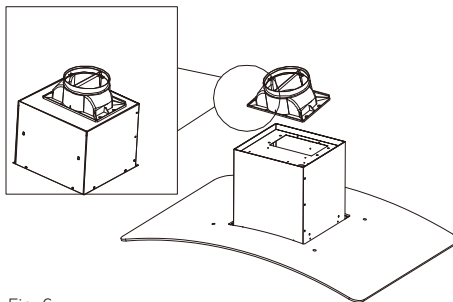

Fig. 6

Screw 4 pieces plastic expanding plugs on ceiling as installation drawing.

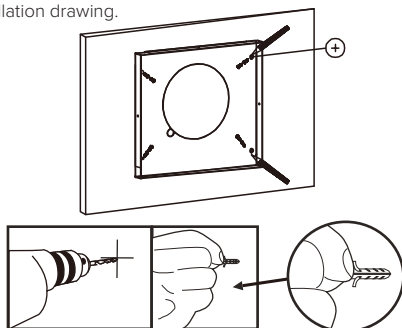

Fig. 7

Fix lower sliding rail on the unit by 16 pieces ST4X10 screws.

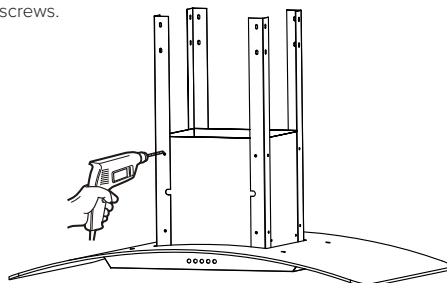

Fig. 8

Fix upper sliding rail on the lower sliding rail by 16 pieces ST4X10 screws.

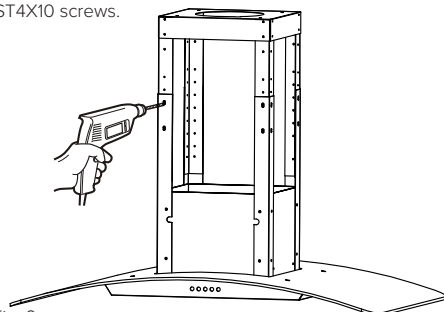

Fig. 9

Install the hose (not supplied) on the damper.

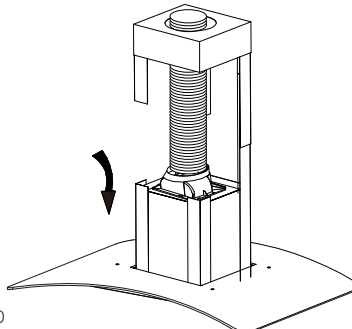

Fig. 10

IMPORTANT SAFETY WARNING: ONLY USE THE SCREWS PROVIDED WITH THE EXTRACTOR TO MOUNT THE DUCTING ADAPTOR. THE USE OF LONGER SCREWS MAY CAUSE DAMAGE TO THE INTERNAL WIRING WHICH WILL NOT BE COVERED BY THE WARRANTY.

Put the outer chimney on the unit.

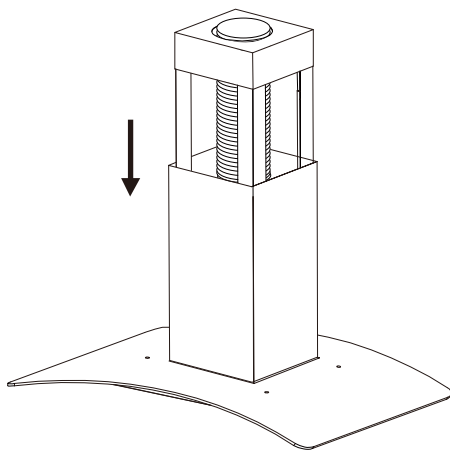

Fig. 11

Put the inner chimney on the unit.

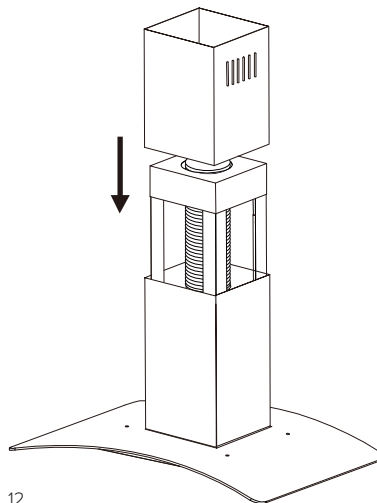

Fig. 12

Fix the unit on the ceiling by 4 pieces ST4X35 screws and fix inner chimney on the bracket by 2 pieces ST4X10 screws.

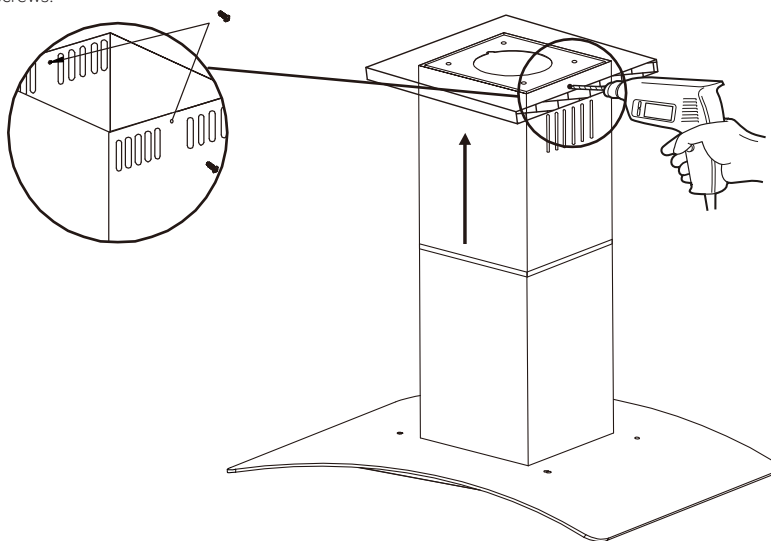

Fig. 13

Take care with the flue/chimney section as the edges can be sharp.

The metal casing of this appliance has been coated with a preservative to protect it during transport and storage. This should be removed during installation by using a non-abrasive stainless steel cleaner. Always follow the instructions given with the cleaner being used.

Energy Efficiency Information

Attribute	Symbol	Value	Units
Model identification		PRCGH100	
Annual Energy Consumption	AEC_{Hood}	40.6	kWh
Time increase factor	f	1.2	
Fluid Dynamic Efficiency	FDE_{Hood}	22.3	
Energy Efficiency Index	EEl_{Hood}	62.0	
Measured airflow at Best Efficiency Point	Q_{BEP}	206.3	m ³ /h
Measured Pressure at Best Efficiency Point	P_{BEP}	348	Pa
Maximum airflow	Q_{MAX}	360.7	m ³ /h
Measured electric power at Best Efficiency Point	W_{BEP}	89.3	W
Nominal lighting power	WL	2.0	W
Average illumination of the lighting system on the cooking surface	E_{Middle}	208	Lux
Measured power consumption in standby	P_s	--	W
Measured power consumption off mode	P_o	0	W
Sound power level	L_{WA}	63	dBA
Grease Filter Efficiency	GFE_{Hood}	55.5(E)	%
Lamp Efficiency	LE_{Hood}	104(A)	%

E & O E. All instructions, dimensions and illustrations are provided for guidance only. PRIMA reserve the right to change specifications without prior notice.



prima

